

R-31-W

POCAHONTAS CO.

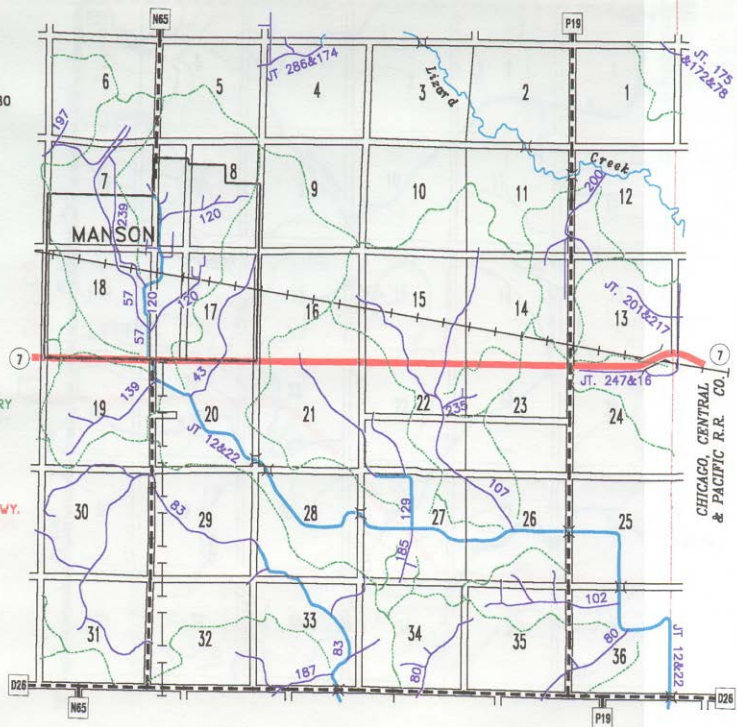

LEGEND

- RIVER
- NATURAL STREAM/CREEK
- D.D. TILE
- OPEN D.D. DITCH
- D.D. WATER SHED BOUNDARY
- 222 COUNTY D.D. NUMBER
- JT. 69&10 JOINT D.D. NUMBER (FIRST NUMBER IS CALHOUN D.D. NUMBER)
- PAVED COUNTY HWY.
- PAVED STATE/FEDERAL HWY.
- GRAVEL ROAD
- BRIDGE
- RAILROAD TRACKS
- PIPE LINE

WEBSTER CO.

T-89-N

CHICAGO, CENTRAL & PACIFIC R.R. CO.