

LEGEND

- OPEN DITCH
- TILE LINES
- WATERSHED BOUNDARY
- INTERIOR DIVIDE
- 1/4 1/4 LINES
- 1/4 LINES
- COUNTY ROADS
- RAILROADS
- SWAMPS
- LOW GROUND
- COUNTY BOUNDARIES

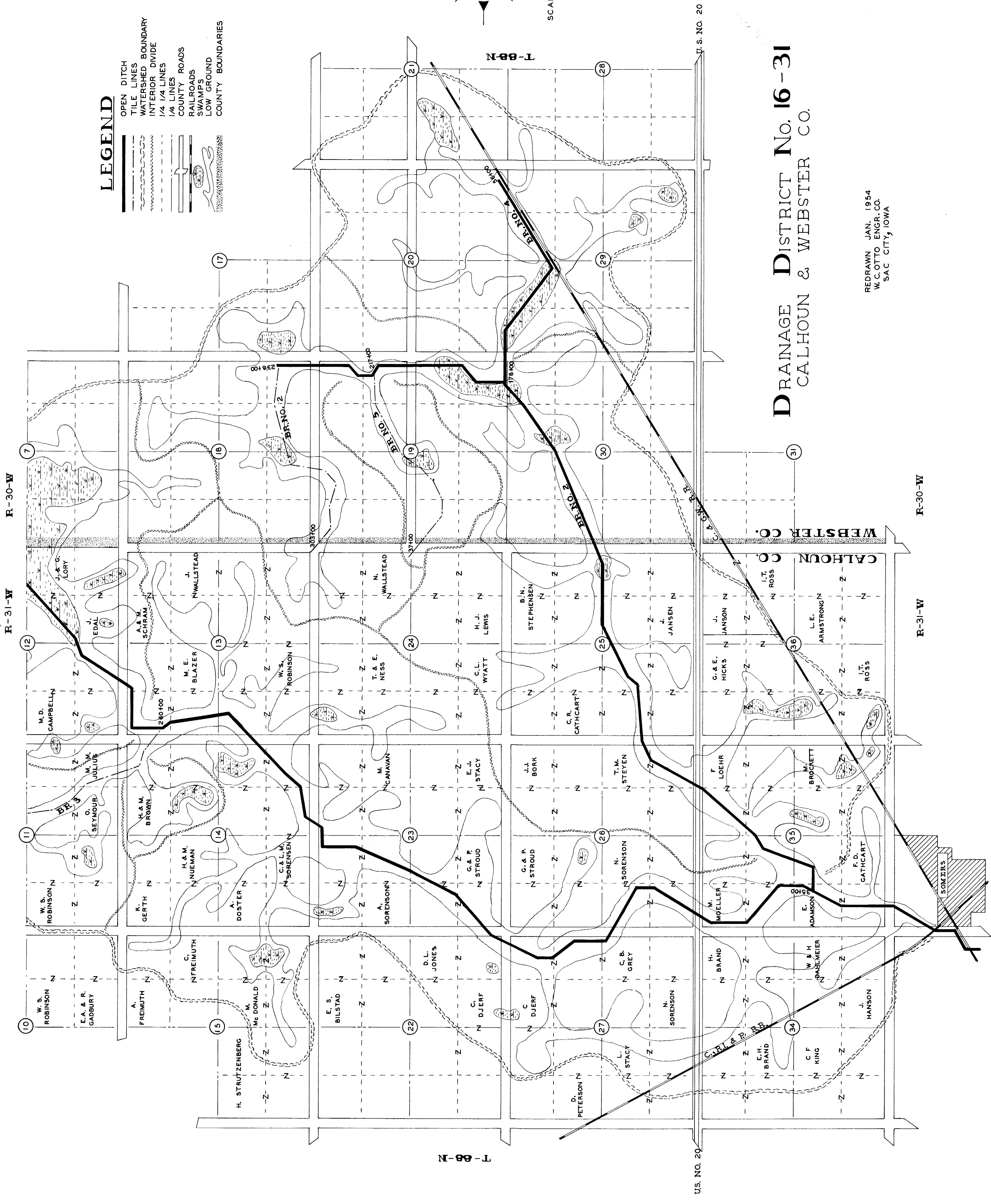
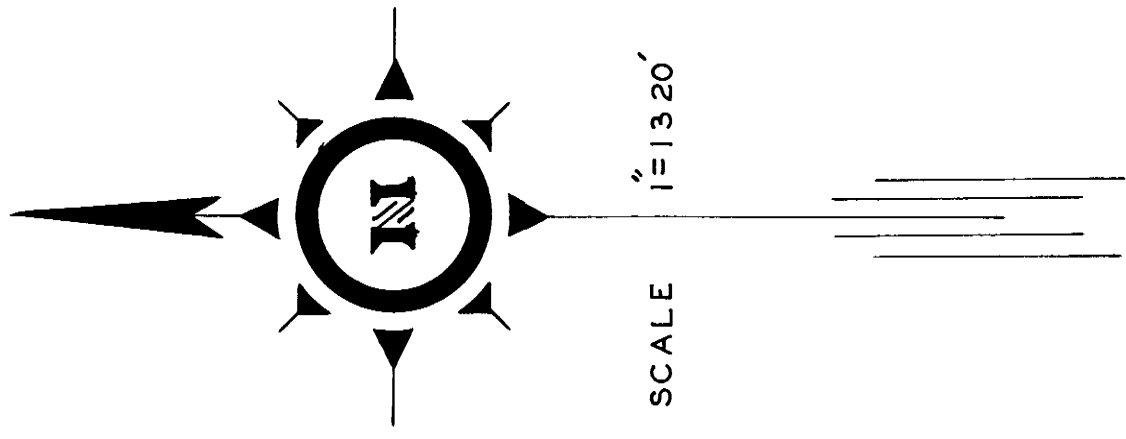

DRAINAGE DISTRICT No. 16-31
CALHOUN & WEBSTER CO.

REDRAWN JAN. 1954
W.C. OTTO ENGR.-CO.
SAC CITY, IOWA