

DRAINAGE-DISTRICT-NO.25
CALHOUN-COUNTY
TWIN LAKES - TWE

TR89N - R33W
 SEC. - 14,15,16,21,22,23
 REDRAWN-W.C.OTTO-ENGR.CO.
 SAC CITY,IOWA
 SCALE-F-800
 JANUARY,1954

W.E.MCCURE-ENGINEER
 MARCH,1907

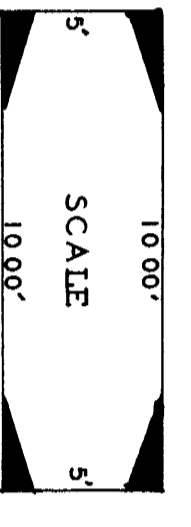
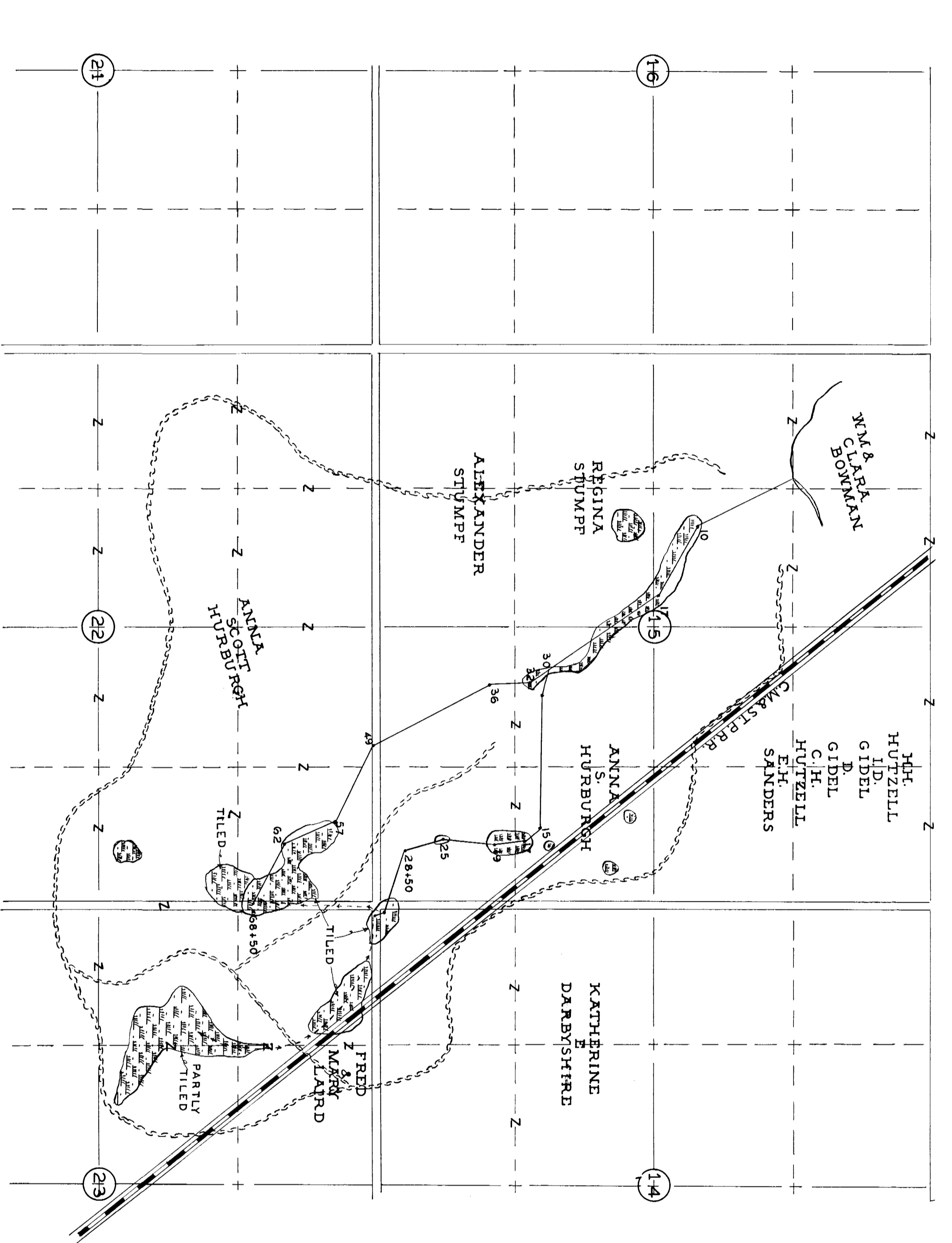

PROFILE - D.D. NO. 25

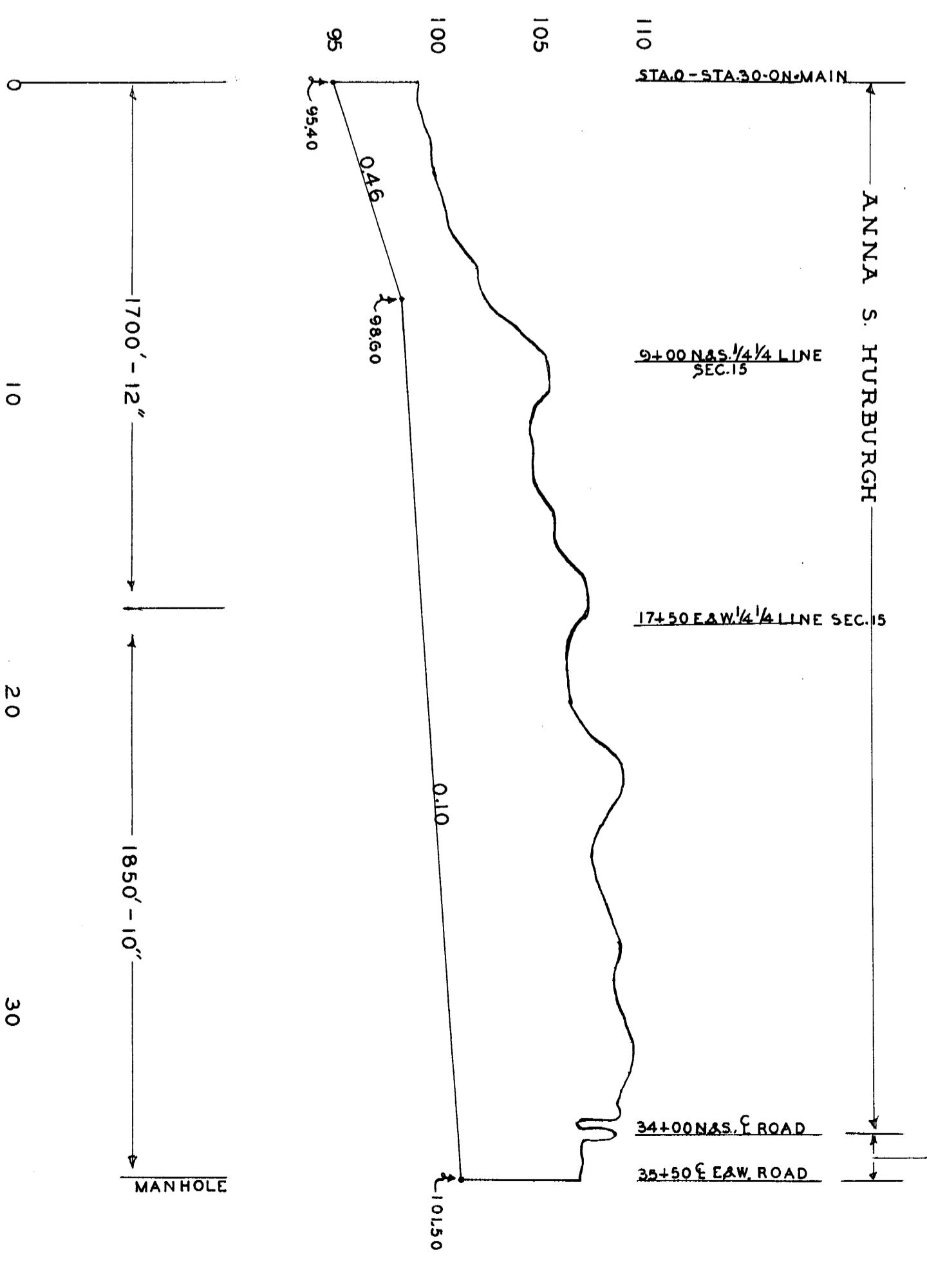
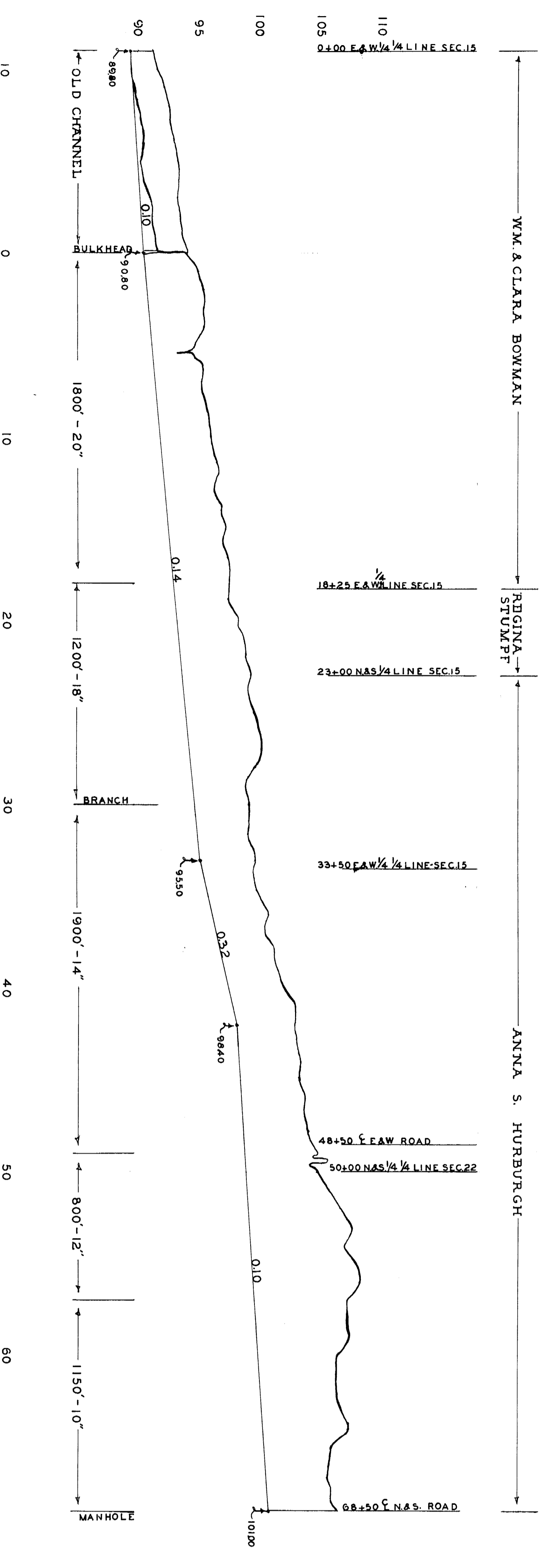

LEGEND
 DISTRICT-BOUNDARY
 OPEN-DITCH
 OLD-TILE
 NEW-TILE
 POND

