

PLAT
OF
D.D. No 28
LOCATED IN
SECS 9-10-15-16-17
20-21-22-27-28-33
34 & 35
READING TWP.
T86N - R31W

SURVEYED DEC. 1905 BY
W.E. MCCLURE, C.E.
REDRAWN JAN. 1954 BY W.C. OTTO ENGR. CO. SAC CITY

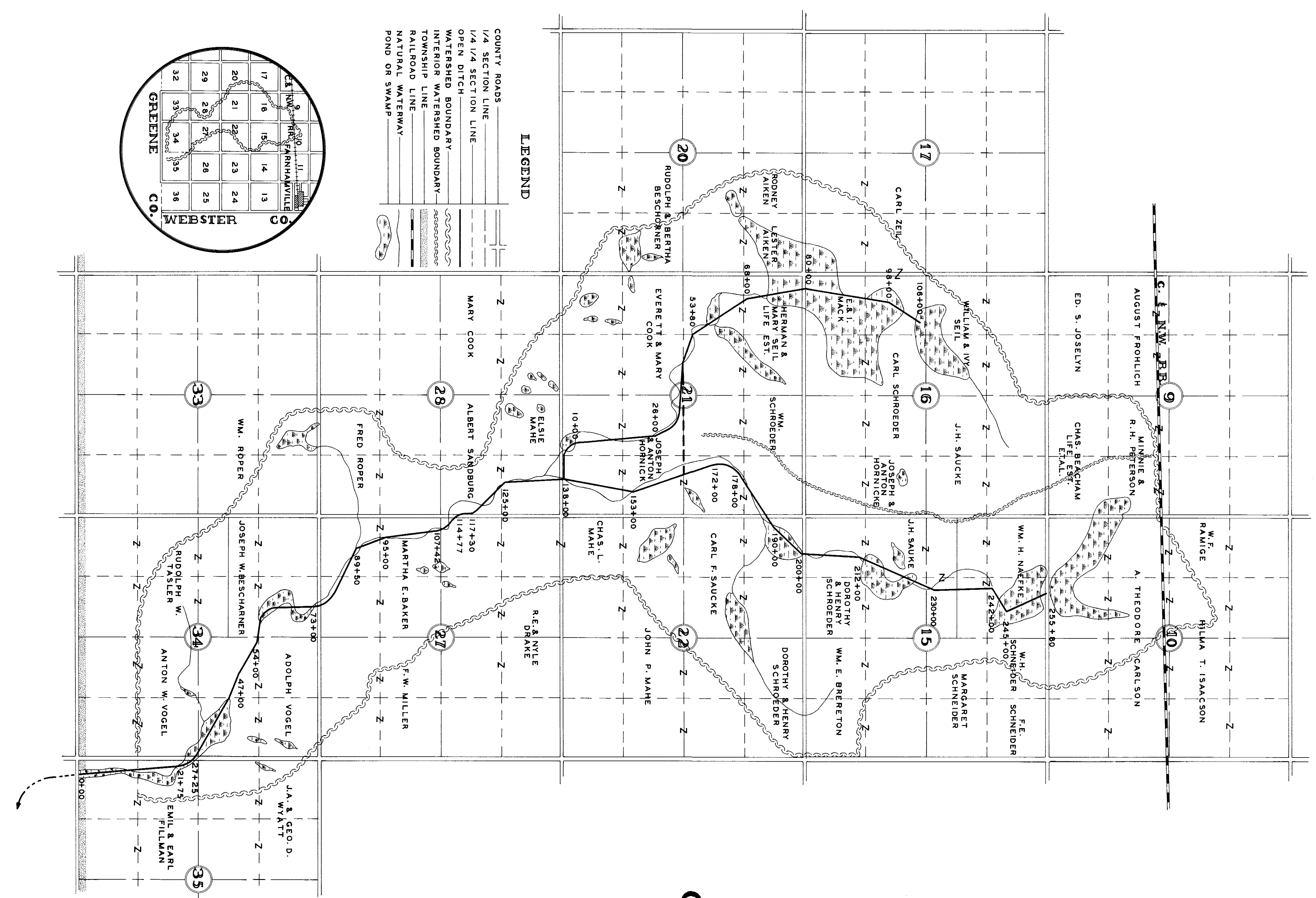

LEGEND

- COUNTY ROADS
- 1/4 SECTION LINE
- 1/4 SECTION LINE
- OPEN DITCH
- WATERSHED BOUNDARY
- INTERIOR WATERSHED BOUNDARY
- TOWNSHIP LINE
- RAILROAD LINE
- NATURAL WATERWAY
- POND OR SWAMP

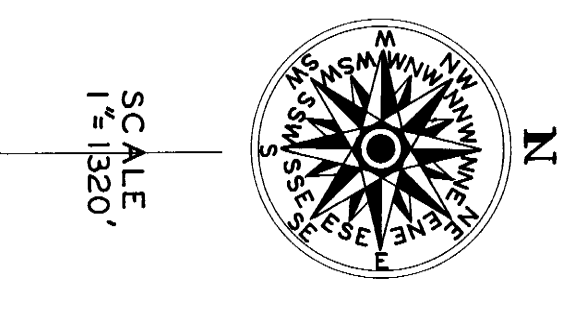
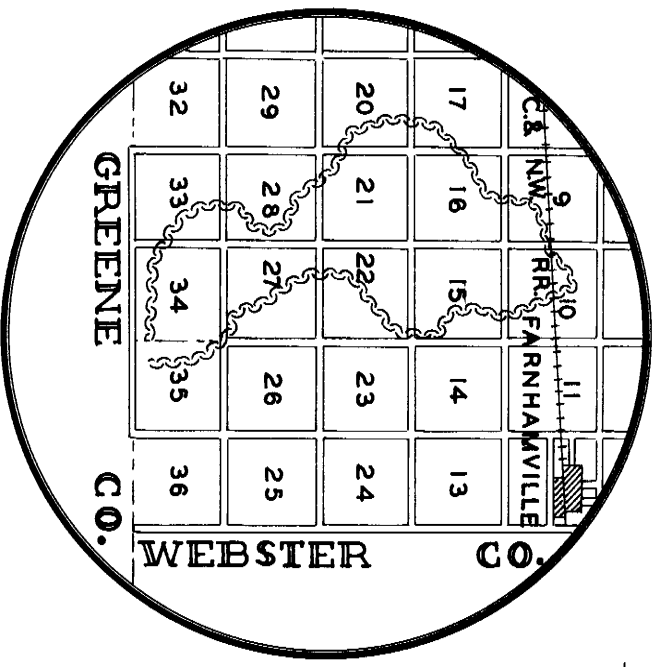

LATERAL B PROPOSED TILE IMPROVEMENT

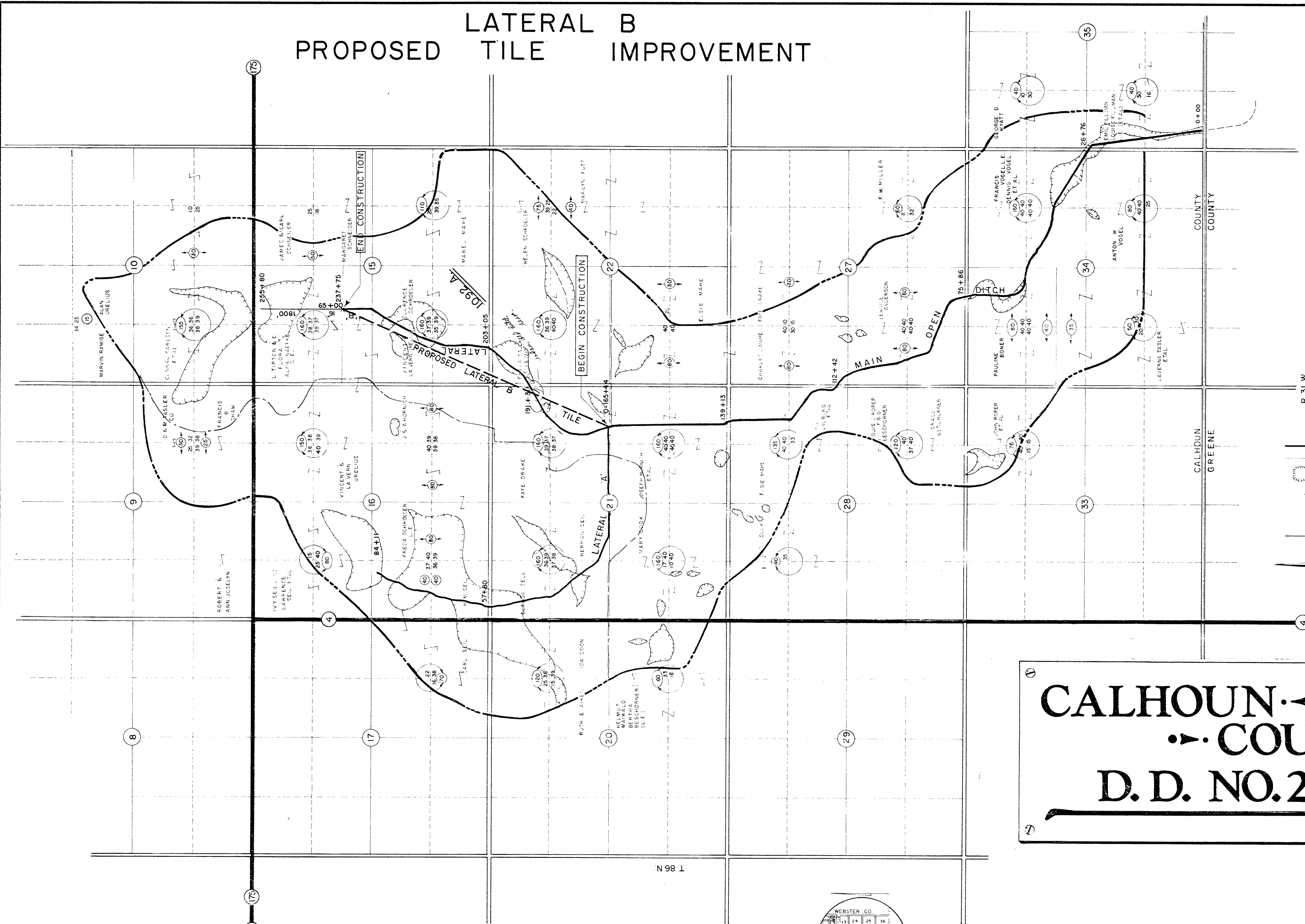

— LEGEND —

- DISTRICT BOUNDARY
- WATERSHED BOUNDARY
- LOWS
- ACRES IAW 1927 & 1907 ASSESSMENTS.
- ACRES IAW ORIGINAL ENGINEERS REPORT.
- TILE
- NORTH
1" = 1000'

CALHOUN COUNTY
D. D. NO. 28

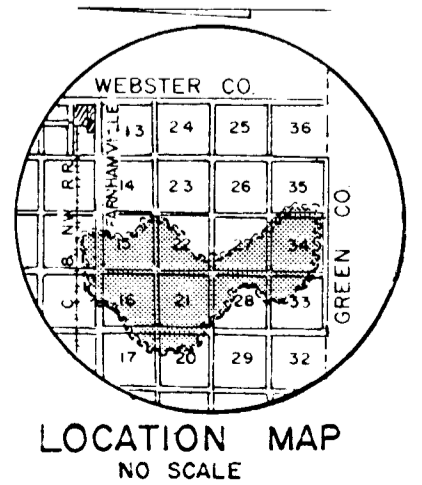
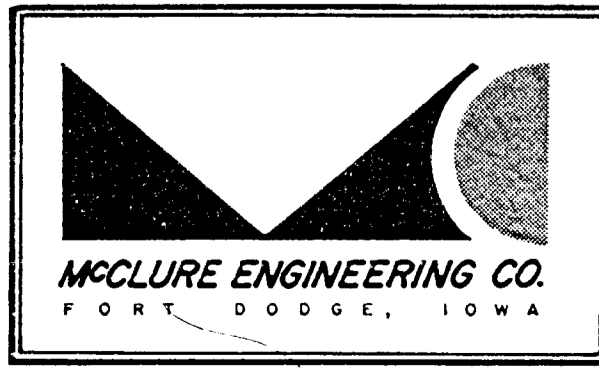

I HEREBY CERTIFY THAT THIS DOCUMENT WAS PREPARED BY ME OR UNDER MY DIRECT SUPERVISION AND THAT I AM A DULY REGISTERED PROFESSIONAL ENGINEER UNDER THE LAWS OF THE STATE OF IOWA.

DATE _____ ENGINEER _____

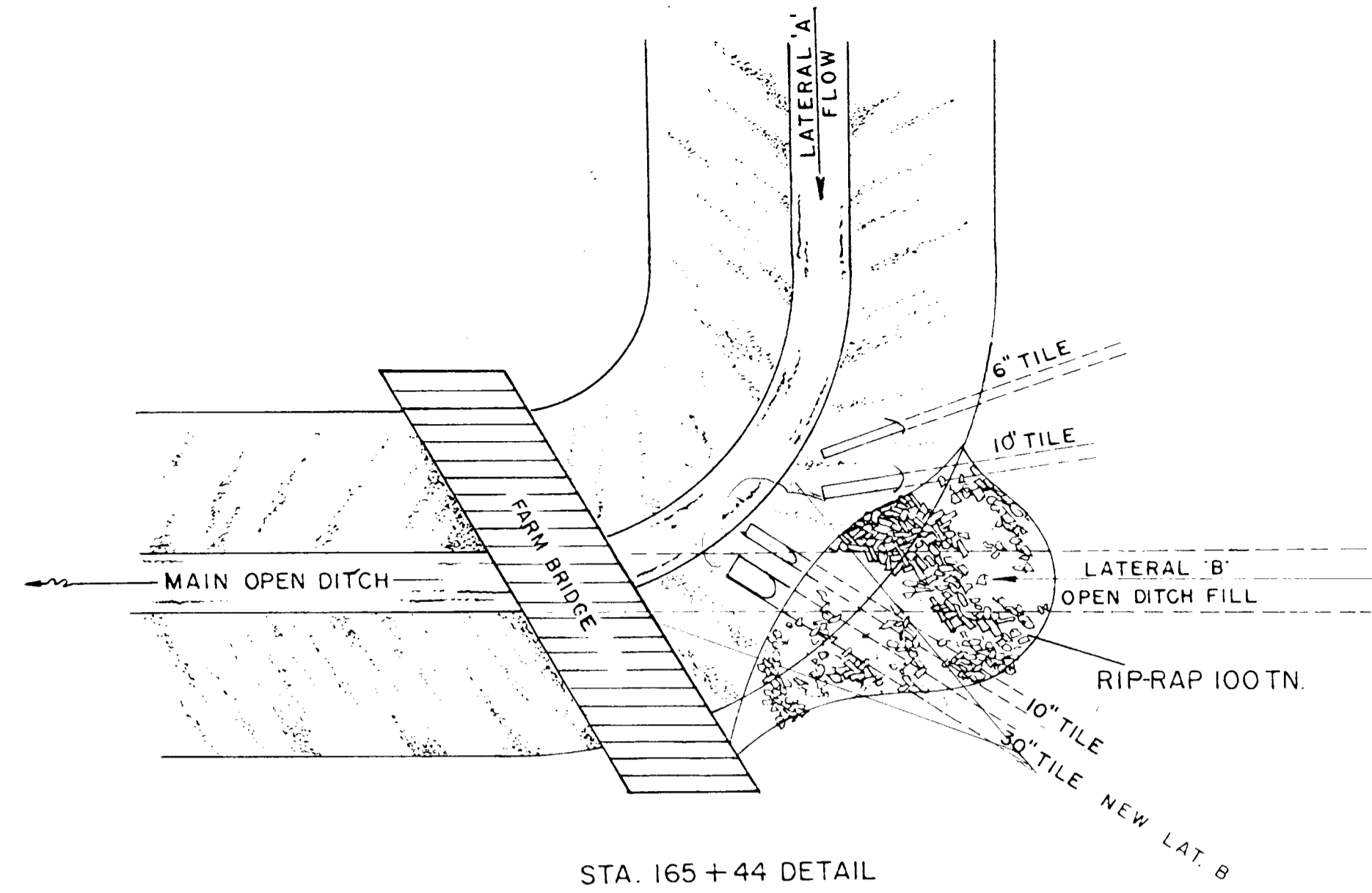

STA. 165+44 DETAIL

- BENCH MARKS
- B.M. # 7 - Top, last full ridge, S. end C.M.P. Road Crossing Station 138+00. Elevation = 78.87
 - B.M. # 9 - Ctr. W. low conc. bridge rail. Station 191+31. Elevation = 89.82
 - B.M. #10 - Top, S. end R.C.P., under farm drive NE cor. intersection S.W. cor. Section 15-86-31. Elevation = 90.96
 - B.M. #17 - Top culv. marker S. side Hwy. 175. Elevation = 96.36

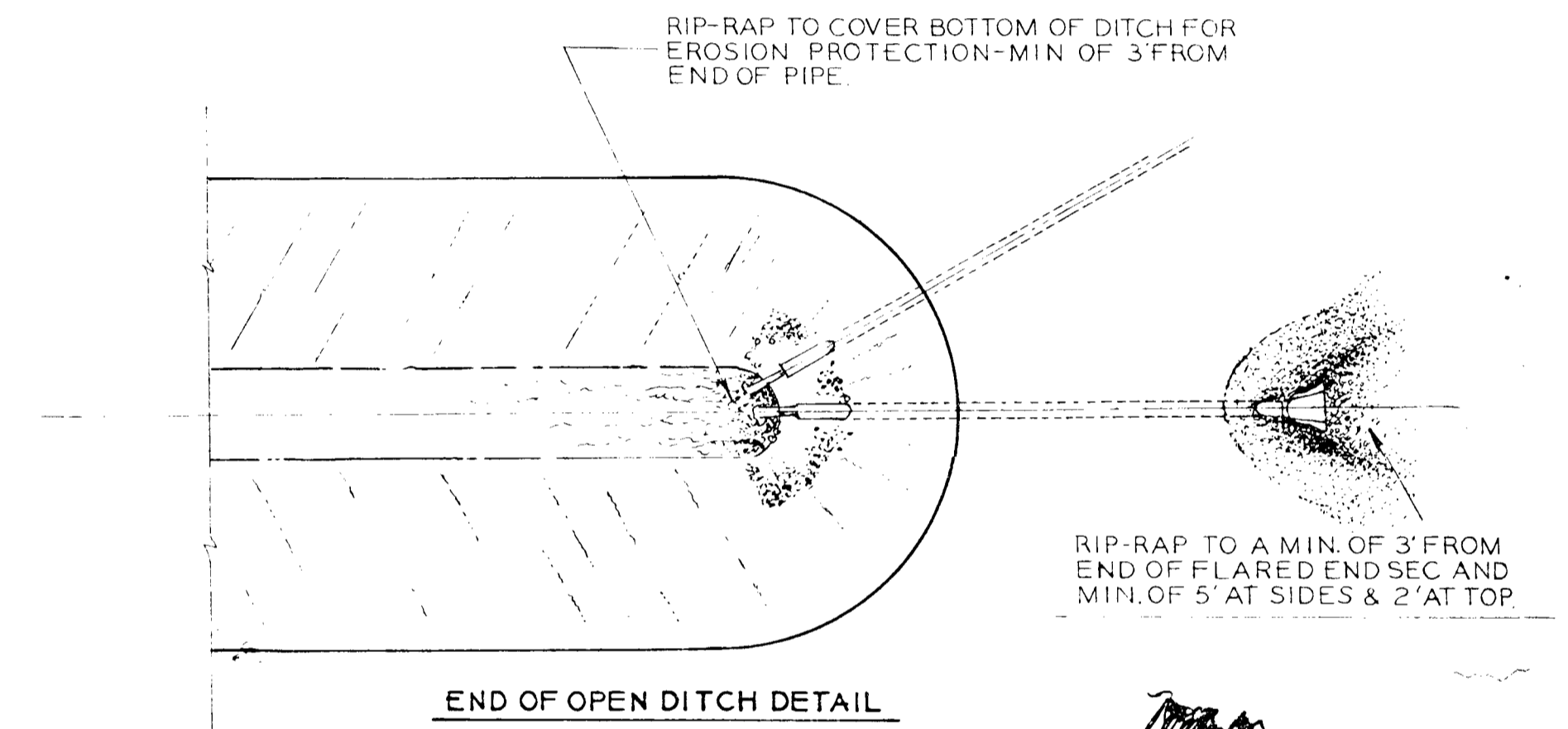

END OF OPEN DITCH DETAIL

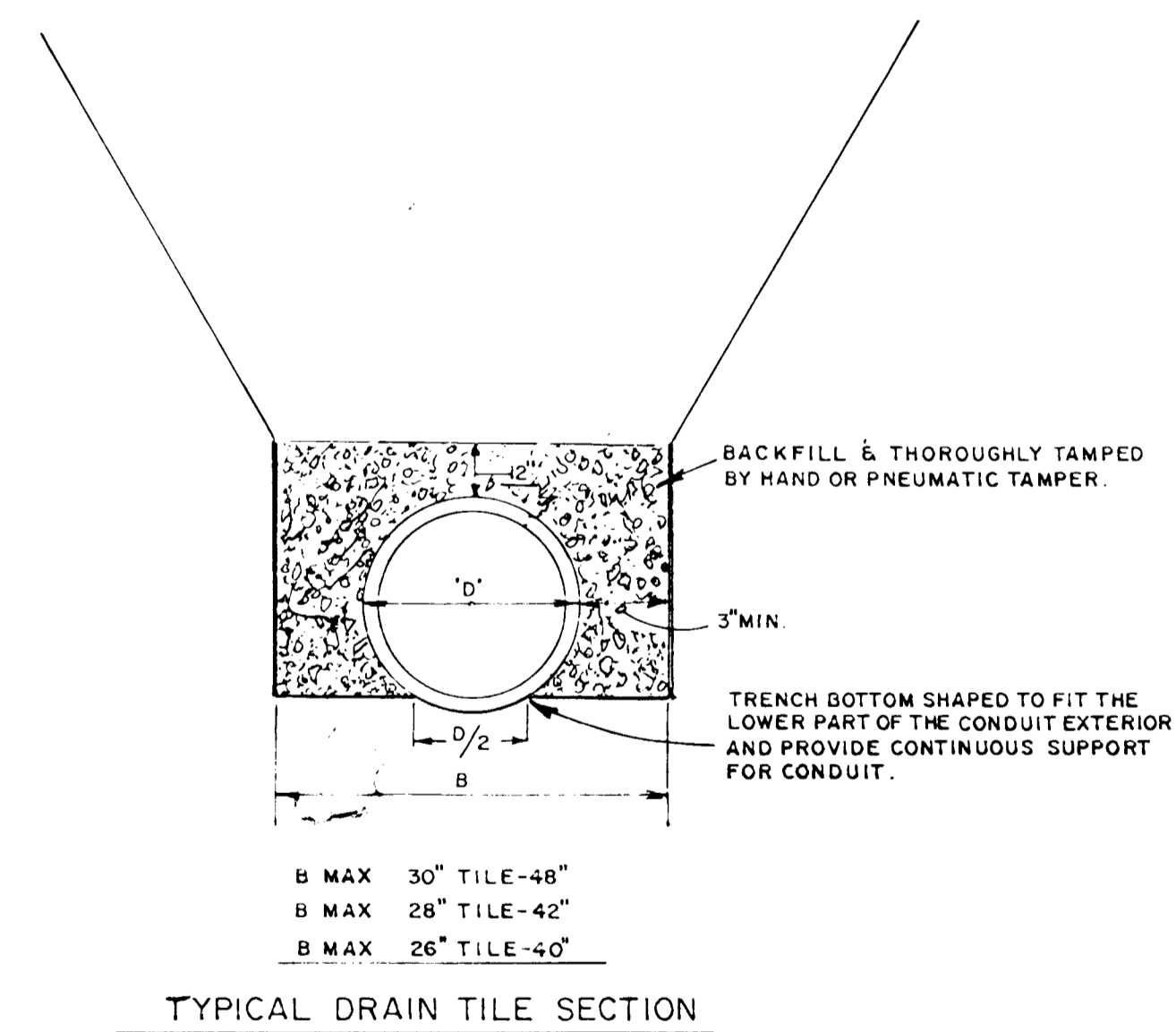

TYPICAL DRAIN TILE SECTION

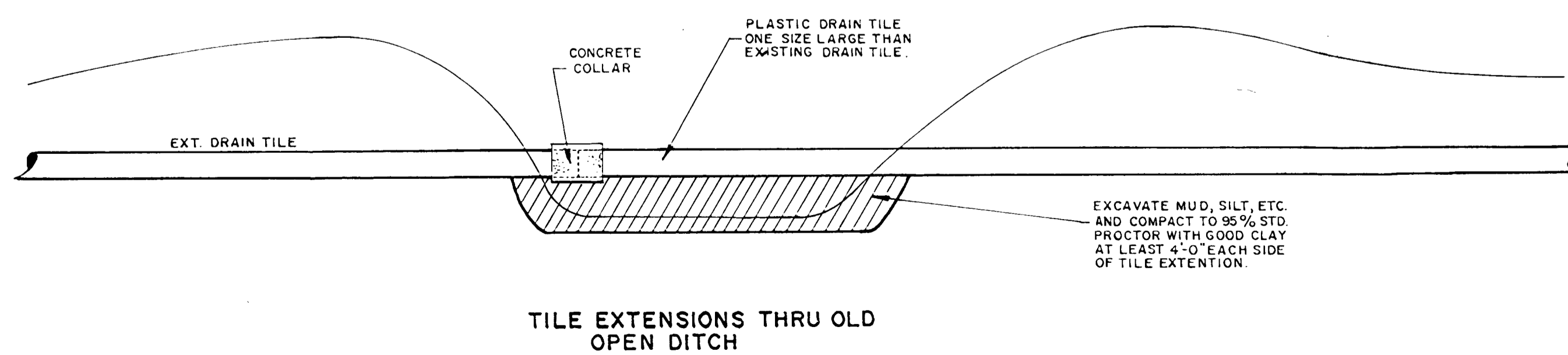

TILE EXTENSIONS THRU OLD OPEN DITCH

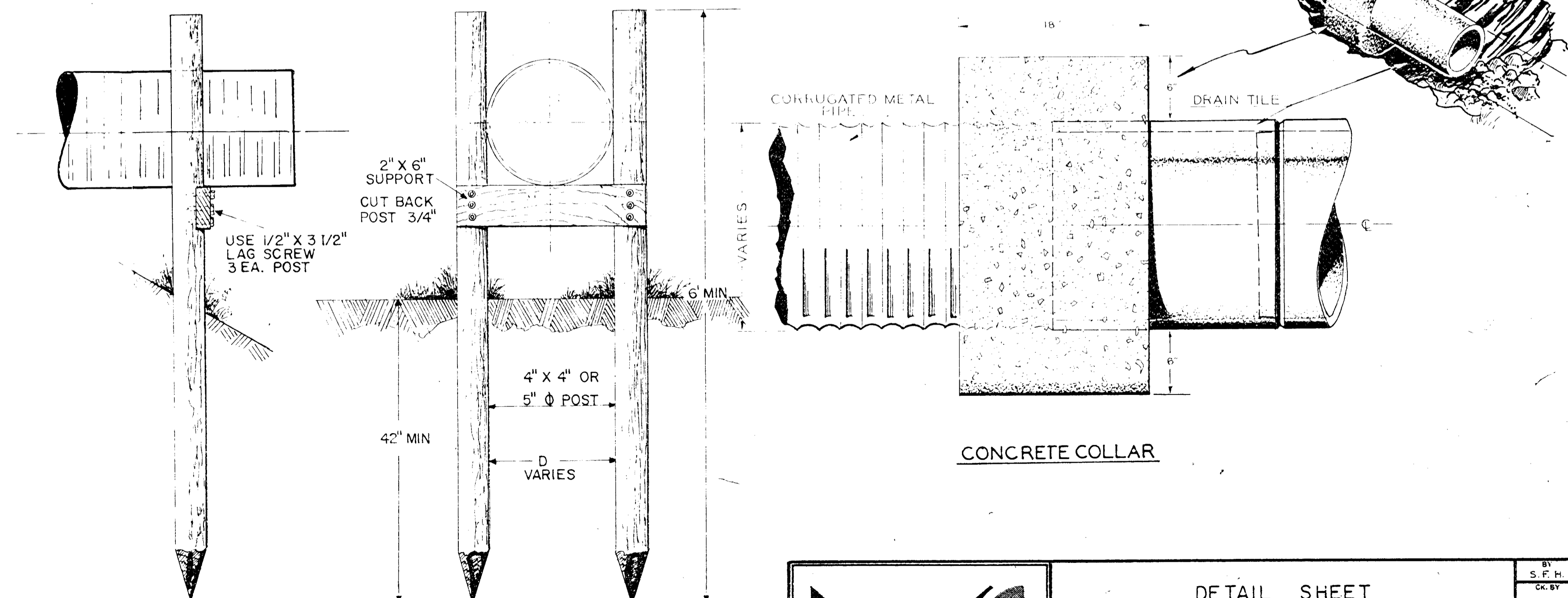

CONCRETE COLLAR

PIPE SUPPORT
NO SCALE

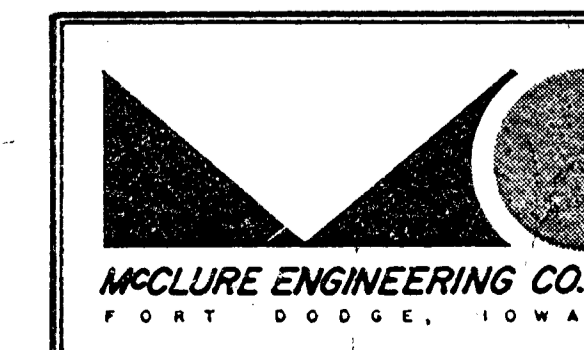

DETAIL SHEET

CALHOUN COUNTY
D.D. 28

BY	S.F.H.
CK. BY	
SCALE SHOWN	
DATE	8-21-72
REV	
SHEET	7/7