

LEGEND	
	OPEN DITCH DD NO 60
	RAILROAD
	STATE HIGHWAY
	COUNTY HIGHWAY
	COUNTY ROADS
	SECTION LINE
	1/4 1/4 LINES
	WATER SHED BOUNDARY
	ASSESSMENT BOUNDARY
	PIPELINE
	TILE

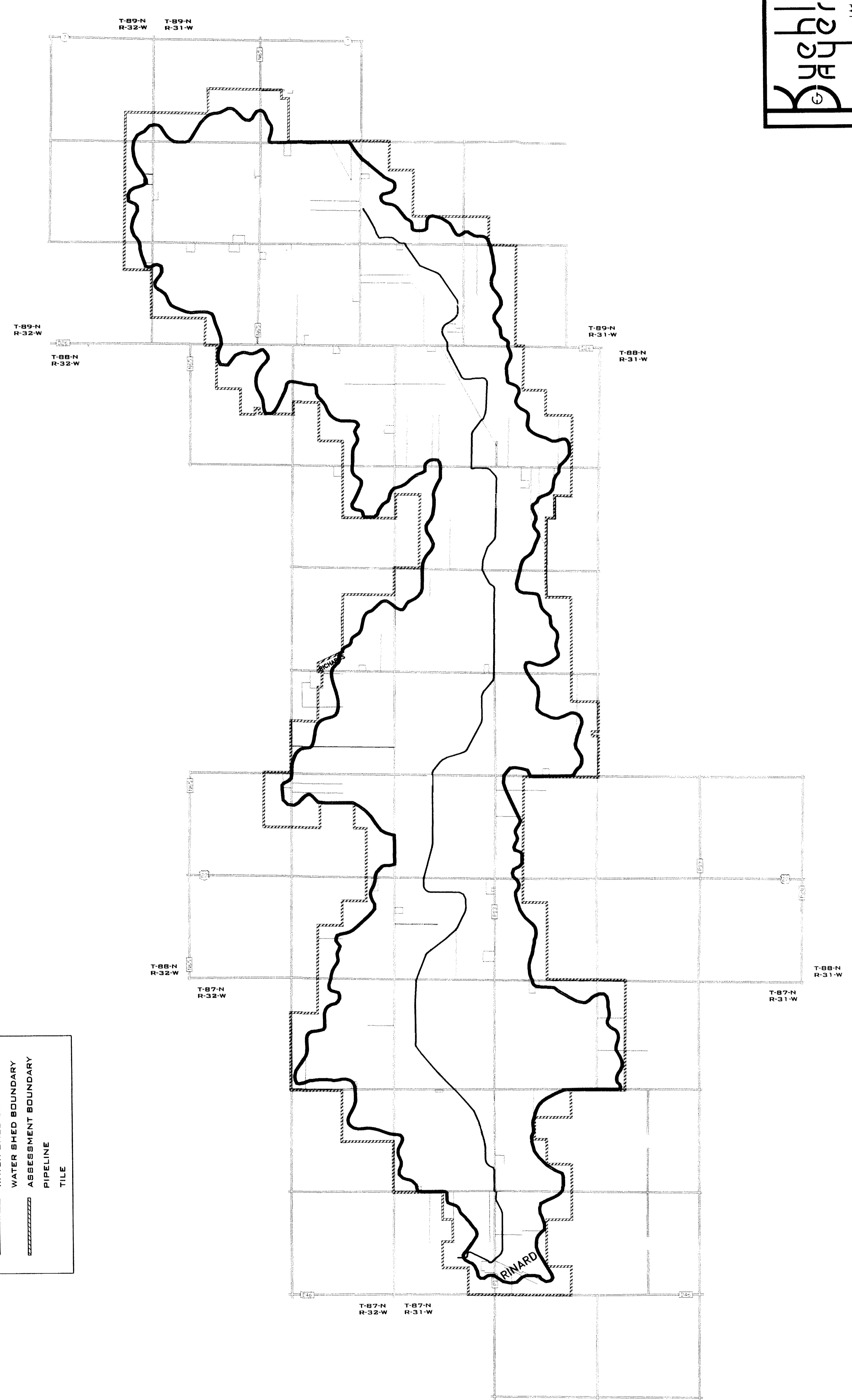
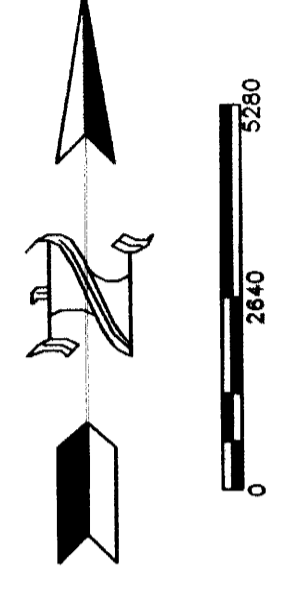

	DESIGN BY:	PROJ. NO.
	I.D.D.	006081
CONSTRUCTING ENGINEERS 1725 N. LAKE AVENUE P.O. BOX 458 STORM LAKE, IOWA 50588 712-732-7745	DRAWN BY:	DATE
	E.D.V.	8-03
	CHECKED BY:	DWG. NO.
	I.D.D.	1 OF 2