

LEGEND
 - - - - - WATERSHED BOUNDARY
 = = = = = OPEN DITCH
 - - - - - D.D. NO. 129 TILE

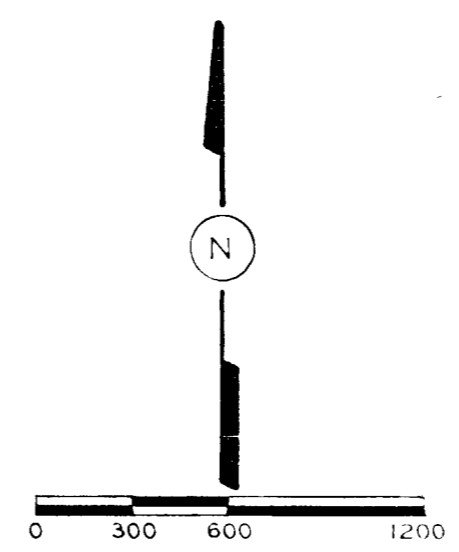

REPAIR-OPEN DITCH CLEANOUT DRAINAGE DISTRICT NO. 129 CALHOUN COUNTY, IOWA LINCOLN TOWNSHIP

PROJECT QUANTITIES						
EXCAVATION	CLEARING & GRUBBING	BANK LEVELING	SURFACE PIPE RIVETED CORRUGATED METAL 16 GAUGE			TILE OUTLET PIPE CORRUGATED METAL 16 GAUGE
			15" DIA	18" DIA	30" DIA	8" 10" 12" 18" 24"
23,315 C.Y.	SEE SCHEDULE EXHIBIT-C	BOTH SIDES 27 STA ONE SIDE 24.86 STA	200 L.F.	10 L.F.	40 L.F.	60 L.F. 20 L.F. 20 L.F. 20 L.F.
			CONNECTING BANDS			60 TON
			5 EA	1 EA	1 EA	

I HEREBY CERTIFY THAT THIS PLAN, SPECIFICATION OR REPORT WAS PREPARED BY ME OR UNDER MY DIRECT PERSONAL SUPERVISION AND THAT I AM A DULY REGISTERED PROFESSIONAL ENGINEER UNDER THE LAWS OF THE STATE OF IOWA.

 HAROLD R. FAIRBAIRN
 DATE 7/27/77 REG NO. _____

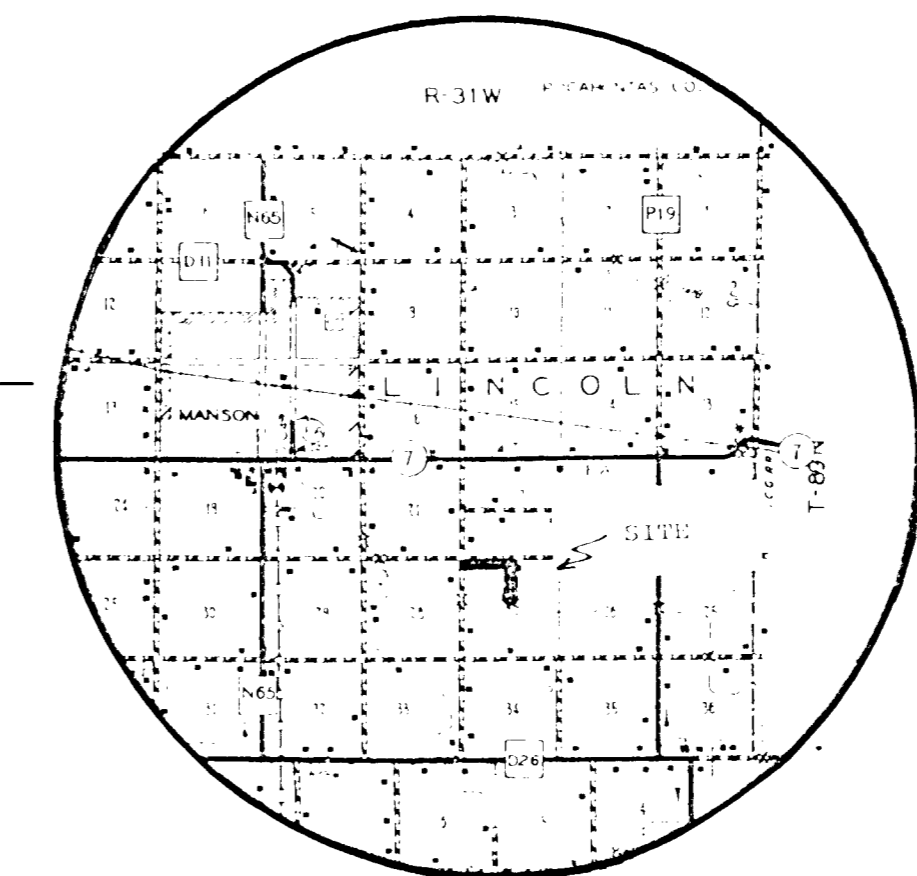

INDEX OF DRAWINGS

DWG. NO.	DESCRIPTION
1	DRAINAGE DISTRICT MAP WITH OWNERSHIPS
2	DITCH PROFILE
3	TYPICAL CROSS-SECTIONS

NO.	REVISIONS	BY	DATE

DRAINAGE DISTRICT MAP WITH OWNERSHIPS

M.H.F. ENGINEERING, P.C.
 ENGINEERS - LAND SURVEYORS
 P.O. Box 68 Jefferson, Iowa 50129
 Ph. (515) 386-4101

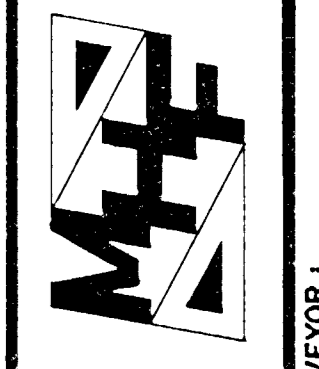

PROJECT NO. 90061
 DWG. NO. 1
 DATE: _____

ENGINEER/ LAND SURVEYOR DRAFTSMAN CHECKER