

PLAT & PROFILE
 OF
 DRAIN NO 132
 CALHOUN COUNTY, IA.
 REDRAWN
 BY
 W.C. OTTO ENGR.
 JAN 1956

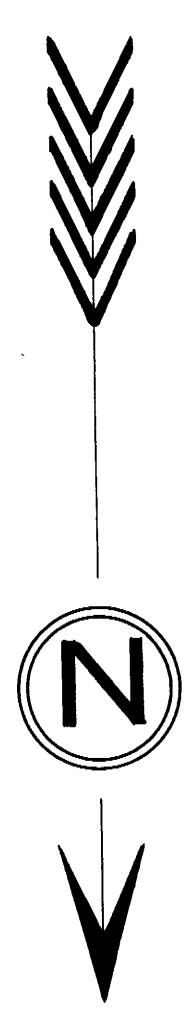

BILL OF MATERIAL

TILE	LENGTH	AV. DEPTH
18"	3000'	6.5'
15"	1000'	8.0'
12"	1500'	5.8'
ONE BULKHEAD		
FOUR CATCH BASINS		
50 CU. YDS. EXCAV.		
12"	500'	5.5'
10"	600'	5.5'
ONE CATCH BASIN		

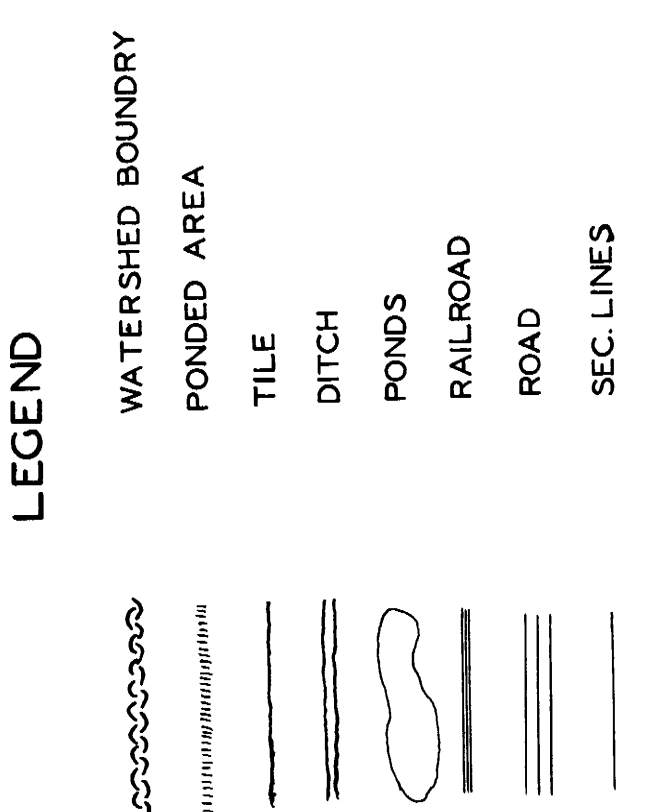
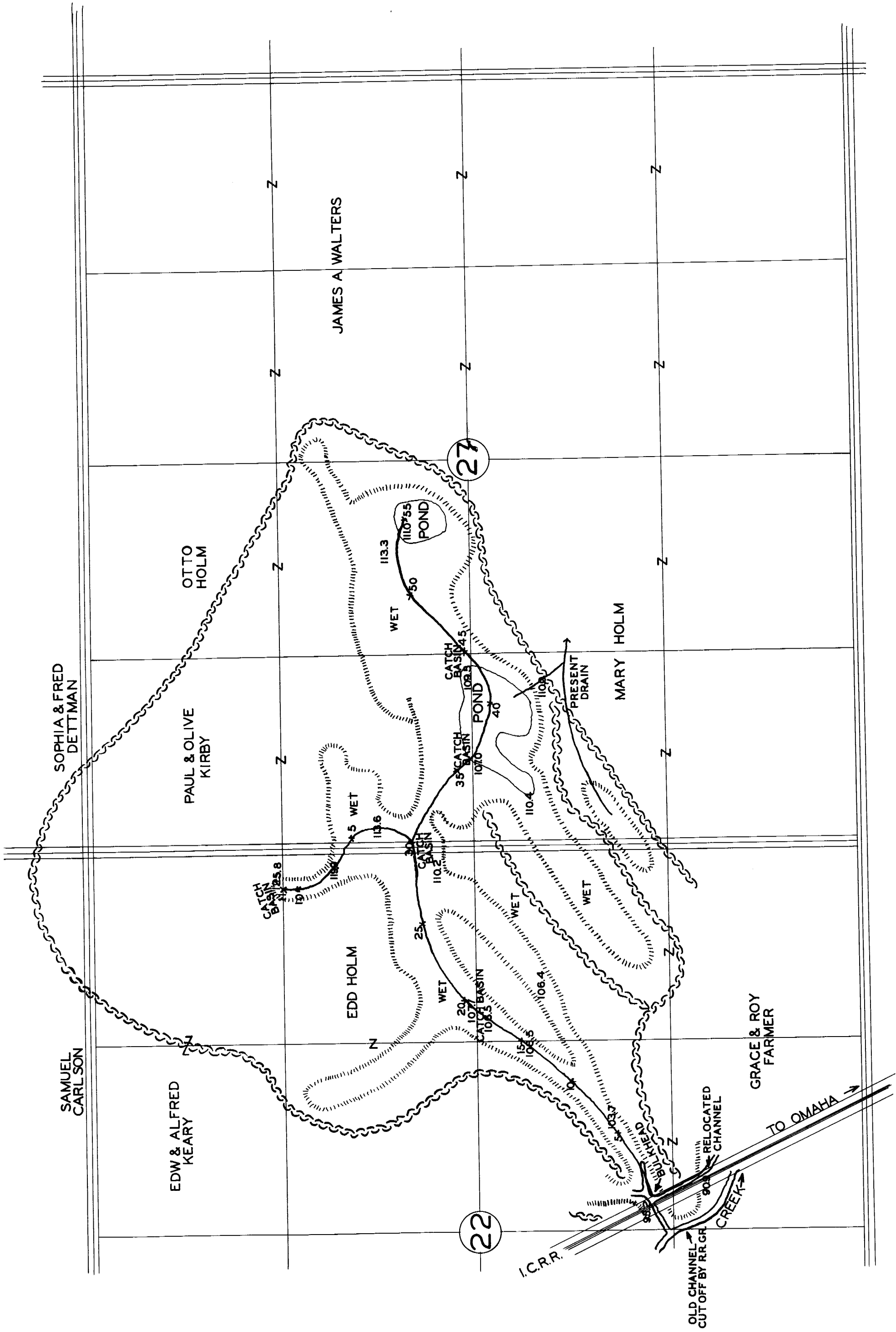