

**PLAT**

DRAINAGE DISTRICT

NO. 136

CALHOUN COUNTY

TWIN LAKES TOWNSHIP

T-88-N. R-33-W.

SECTION 21, 22, 27, 28.

DRAWN BY

W.E. CLURE

1909

REDRAWN BY

McOTTENGR. CO.

SAC CITY, IOWA

1956

**LEGEND**

- PROPOSED-TILE
- OPEN-DITCH
- WET-LAND
- WATER-SHED-BOUNDARY

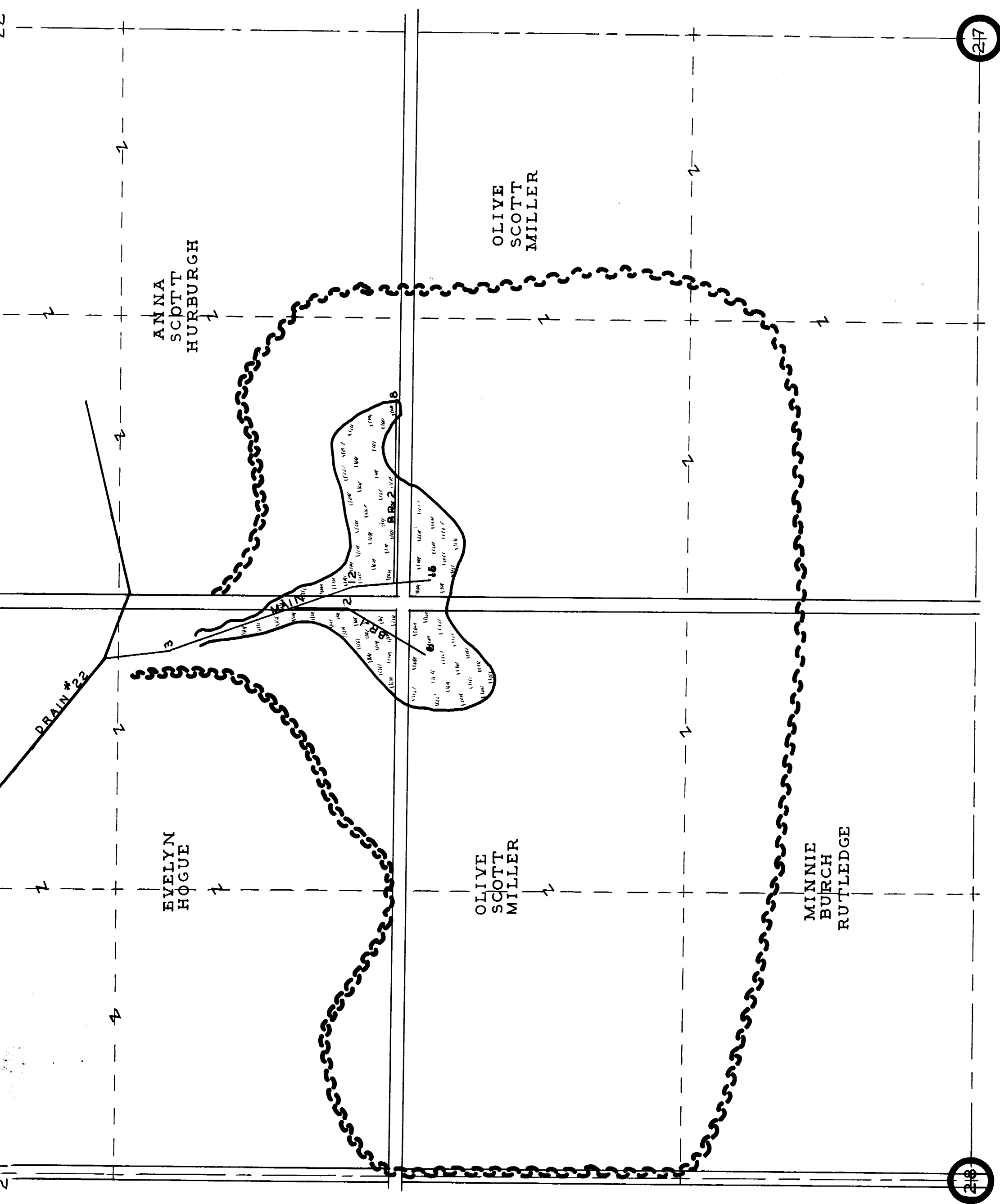

**PROFILE**

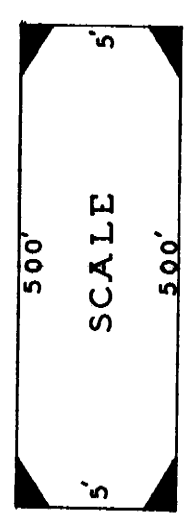

**MAIN**

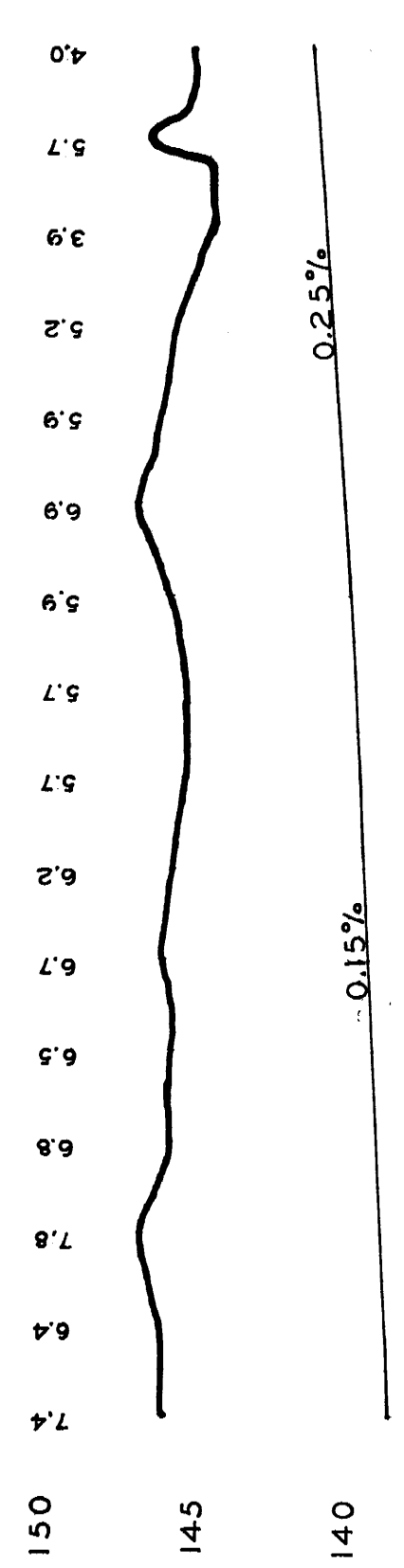

0-9+00-900'-12" TILE-AVE-DEPTH-8.5'  
 9+00-15+00-600'-10" TILE-AVE-DEPTH-33'  
 S. 13° E. | S. 27° E. | S. 15° E.  
 SE 1/4 - SEC. 21 - 88 - 33 EVELYN - HOGUE 5  
 SW 1/4 - SEC. 22 - 88 - 33 ANNA - SCOTT - HURBURGH 10  
 NW 1/4 - SEC. 27 - 88 - 33 OLIVE - SCOTT - MILLER 15

**BRANCH #1**

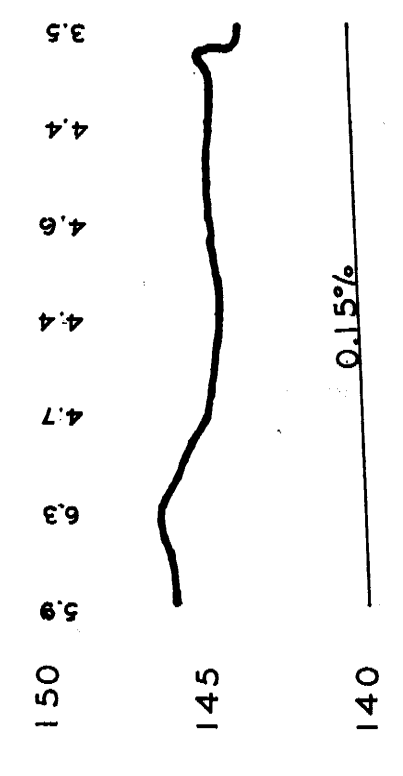

0-6+00-600'-10" TILE-AVE-DEPTH-4.8'  
 SOUTH | S. 19° W.  
 SE 1/4 - SEC. 21 - 88 - 33 EVELYN - HOGUE 5  
 NE 1/4 - SEC. 28 - 88 - 33 OLIVE - SCOTT - MILLER 6

**BRANCH #2**

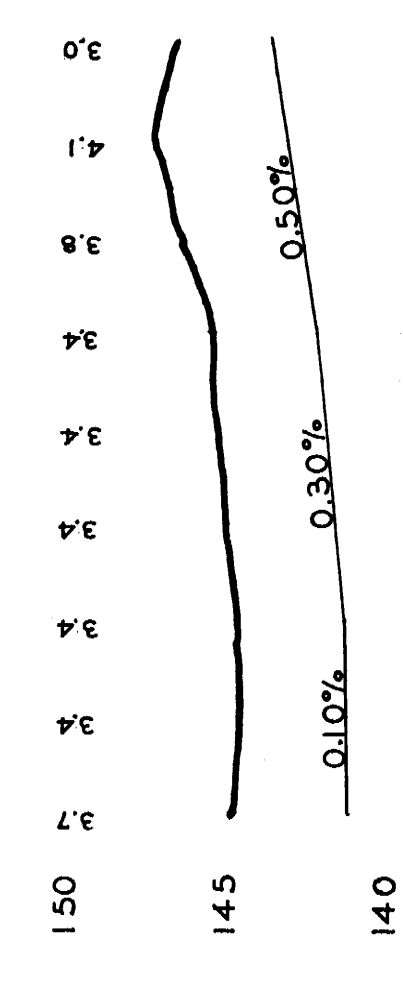

0-6+00-800'-6" TILE-AVE-DEPTH-33'  
 EAST  
 SW 1/4 - SEC. 22 - 88 - 33 ANNA - SCOTT - HURBURGH 7