

PLAT OF  
JOINT DRAINAGE DISTRICT  
NO. 195 CALHOUN COUNTY  
NO. 51 SAC COUNTY

SURVEYED DEC. 1914  
BY S. J. MELSOU ENGR.  
REDRAWN MARCH 1958  
BY W. C. OTTO ENGR. CO.  
SAC CITY, IOWA

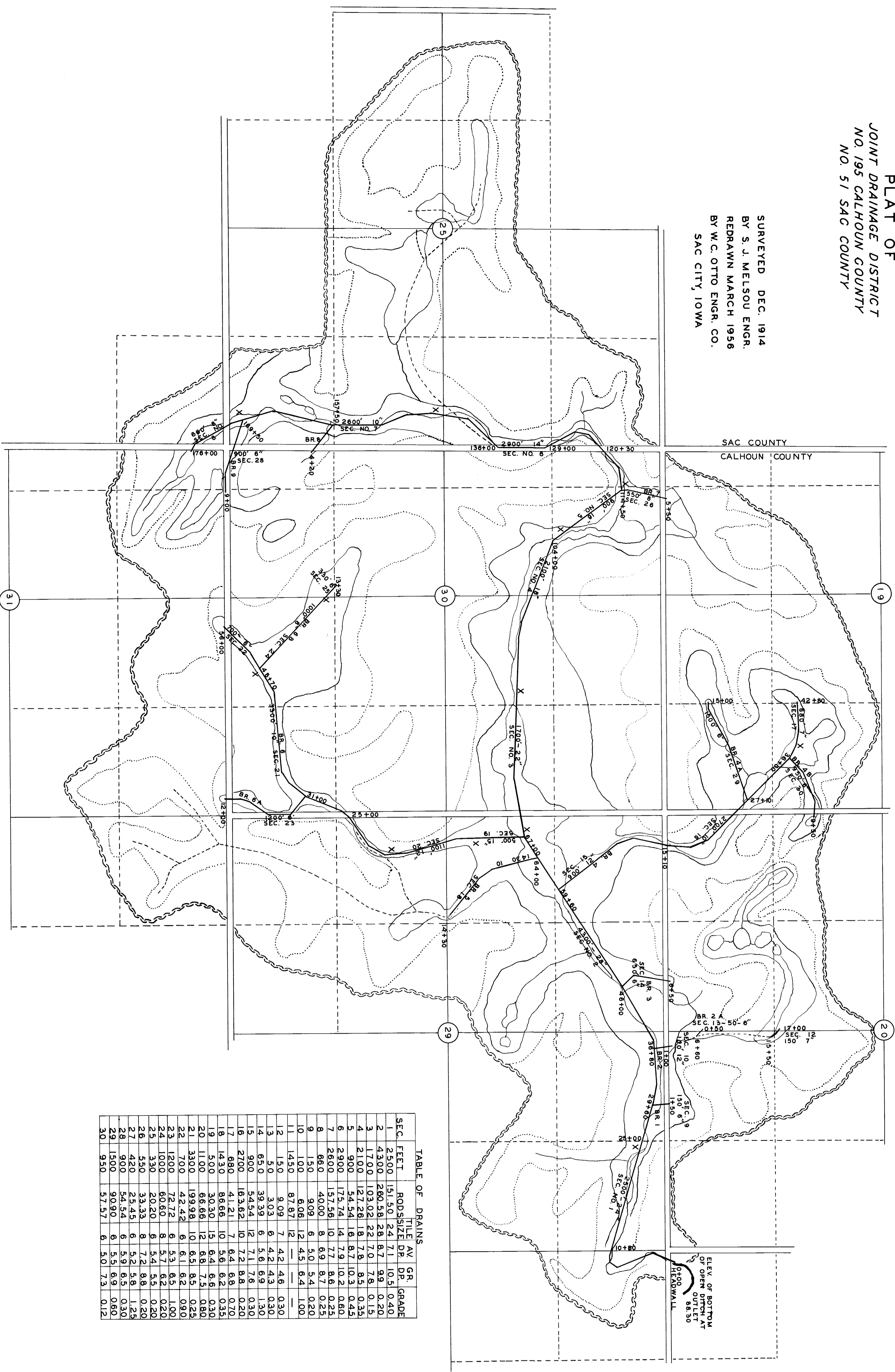

TABLE OF DRAINS

SEC. FEET	RODS	FILE SIZE	AV. DP.	GR. DP.	GRADE
1	2500	151.50	24.71	10.5	0.40
2	4300	280.38	28.87	7.8	0.20
3	1700	103.02	22.70	6.3	0.15
4	2100	127.26	18.78	6.3	0.33
5	900	54.54	18.67	10.3	0.43
6	2900	174.74	14.77	10.2	0.60
7	2600	157.56	10.77	8.6	0.23
8	660	40.00	8.69	8.7	0.23
9	150	9.09	6.50	5.4	0.20
10	100	6.06	12.45	6.4	1.00
11	1450	87.87	12	—	—
12	150	9.09	7.42	4.6	0.30
13	50	3.03	6.42	4.3	0.30
14	650	39.39	6.56	6.9	1.30
15	900	54.54	12.71	7.6	0.30
16	2700	163.62	10.72	8.8	0.20
17	680	41.21	7.64	6.8	0.70
18	1430	86.66	10.56	6.2	0.35
19	500	30.30	15.64	6.6	0.30
20	1100	66.66	12.68	7.5	0.80
21	3300	199.98	10.65	8.5	0.25
22	700	42.42	6.61	6.2	0.90
23	1200	72.72	6.53	6.5	1.00
24	1600	96.00	6.57	6.2	0.20
25	330	20.20	6.54	5.5	0.20
26	330	32.33	6.72	8.8	0.20
27	420	23.43	6.52	6.8	1.25
28	900	54.54	6.51	6.5	0.30
29	1900	90.80	6.53	6.9	0.60
30	950	57.57	6.50	7.3	0.12

SCALE 1"=600'

