

SCALE 1" = 400'

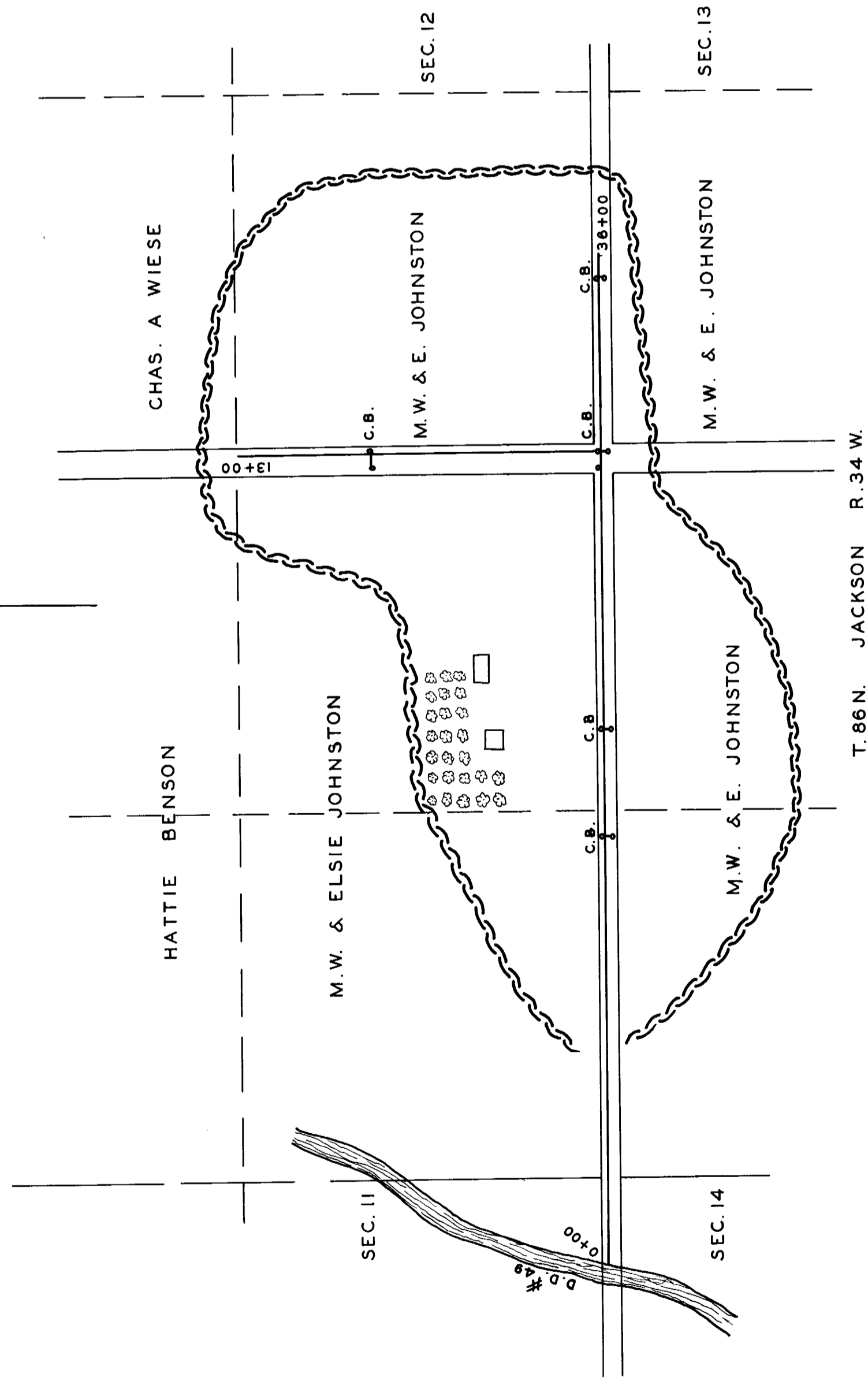

**PLAT AND PROFILE
OF
DRAINAGE DISTRICT NO. 217
#3**
LOCATED ON SOMERS ROAD NO. 3
BETWEEN SECS. 11 & 12 CEDAR TWP.
CALHOUN COUNTY

DRAWN BY W.E. MC-CLURE MAY 1916
REDRAWN BY W.C. OTTO ENGR CO.
SAC CITY IOWA MARCH 1956