

PLAT AND PROFILE OF DRAINAGE DISTRICT NO. 257 CALHOUN COUNTY IOWA

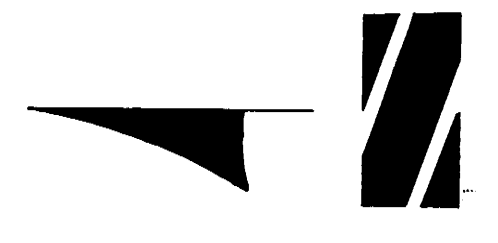

SCALE 1" = 500'

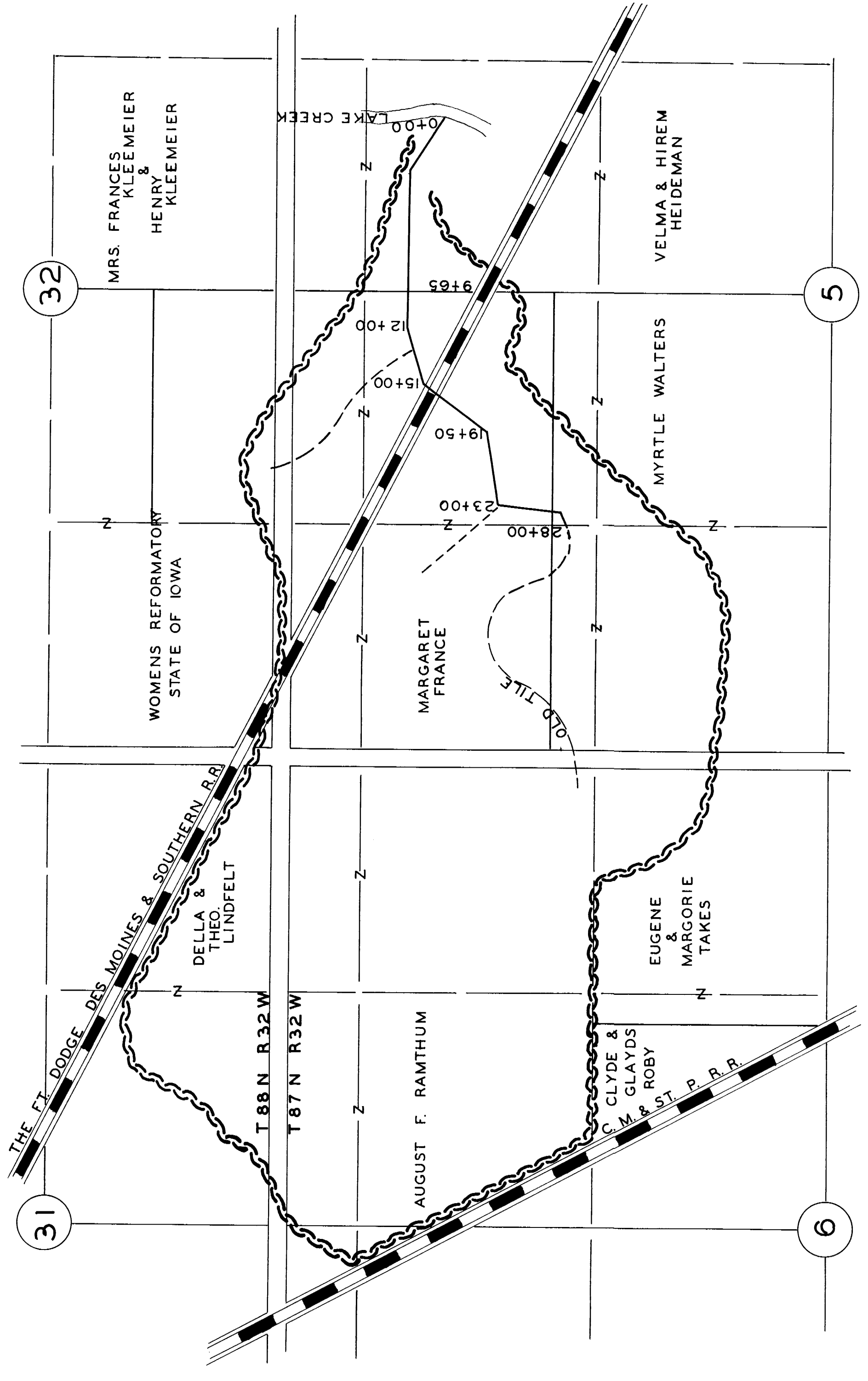

SURVEYED MARCH 1927
BY J. P. MOORE ENGR.
REDRAWN MARCH 1956
BY W. C. OTTO ENGR. CO.
SAC CITY, IOWA

